

EN

RU

ES

DE

FR

KR

PT

IT

JP

AE

Capsule Coffee Machine

SKU / H15

Read this manual thoroughly before using and save it for future reference

Chapter I: Precautions for Safe Use

When using electrical appliances, basic safety precautions should be followed to reduce the risk of fire, electric shock, and injury to persons or property. Read all instructions before using any appliance.

1. In case of emergency: Unplug the electrical outlet immediately.
2. This product is only used in the home or hotel room, any commercial or improper use of the machine does not follow the instructions, the manufacturer does not assume any responsibility, if not used for a long time, please unplug.
3. The power supply voltage must be consistent with the information listed on the label. Please use an outlet with ground wire.
4. To avoid fire, place the coffee machine on a flat, heat-resistant surface and do not use it near an open flame.
5. Regardless of any kind of damage to the coffee machine, please do not use! When there is abnormal noise or odor, turn off the coffee machine and disconnect the power supply. In this case, please contact the authorized service center or distributor.
6. Slide the slide under normal conditions. Do not place your hand on the mouth of the capsule.
7. Do not open the slide cover while the machine is running to avoid danger.
8. Do not use the machine without the waste capsule box and tank.
9. Keep the machine and wires out of reach of children.
10. Do not inject hot water into the water tank, and do not immerse the appliance in water.
11. Do not disassemble the machine or put anything other than the designated capsule at the mouth of the capsule.
12. Except for normal use, cleaning and maintenance, any operation not within the scope of this manual can only be carried out by the authorized service center.
13. Use when the power cord is intact (if the power cord is damaged, it must be replaced by the manufacturer, its maintenance department or similar professionals to avoid danger).
14. Do not place the power cord on hot surfaces, sharp edges or other sharp objects.
15. Do not suspend the power cord (tripping risk).
16. Never touch the wire with wet hands.
17. Do not pull the plug by pulling the wire.
18. Children over 8 years old may use this coffee maker in a safe manner under supervision and should be aware of the associated hazards.
19. Children under 8 years of age are strictly prohibited from cleaning and servicing the coffee machine.
20. Keep coffee makers and power cords away from children under 8 years of age.
21. This coffee machine is not intended for use by children or persons with mental or physical disabilities (unless such persons have fully understood the operation and use of this coffee machine). Persons who have not fully mastered the operation and use of this coffee machine should carefully consult this manual and fully understand its contents. If necessary, help understand how to use it.
22. Clean the coffee machine regularly and carefully.
23. If the coffee machine is not cleaned, long-term buildup can be harmful to your health.
24. Unplug and allow the coffee maker to cool naturally before cleaning.
25. The packaging material is recyclable.
26. To protect the environment, the machine contains materials that can be recycled or reused, please collect them yourself.

Chapter II: Component Description

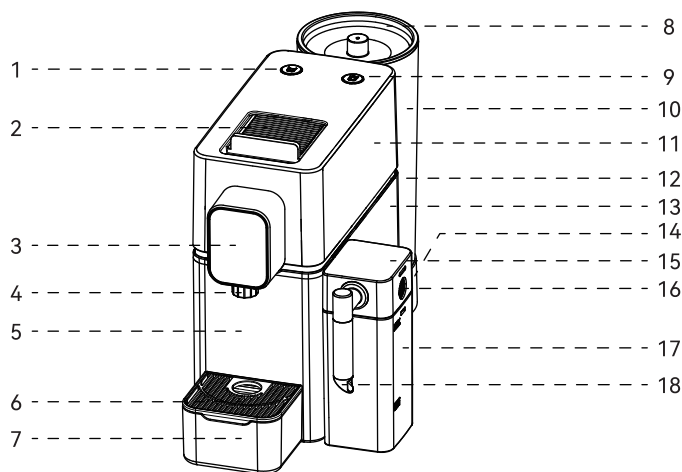

1. Coffee Button	2. Decorative Cover	3. Decorative Cover
4. Coffee Spout	5. Waste Capsule Box	6. Drip Tray Cover
7. Drip Tray	8. Tank Cover	9. Cappuccino Button
10. Water Tank	11. Up Cover	12. Metal Trim
13. Fuselage Panel	14. Tank Base	15. Milk Can Lid
16. Milk Can Switch Button	17. Milk Container	18. Milk Tube

EN

Chapter III: Operation Instruction

1. Preparation before use

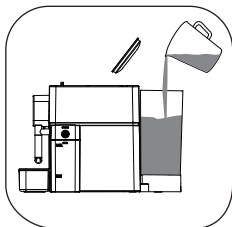

1.Open the tank cover and add clean room temperature water.

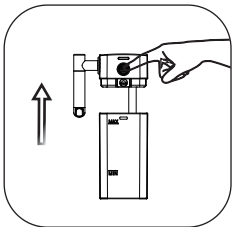

2. Push the button on the milk jar and remove the lid.



3. Add milk (no higher than MAX) to the milk jug.

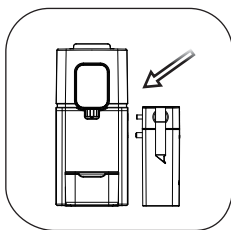

4. Put the lid on the milk can, align the milk can with the jack on the side of the machine, and install it.

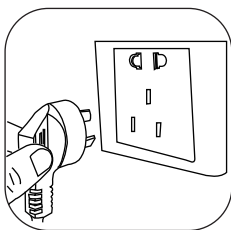

5. Turn the machine on.

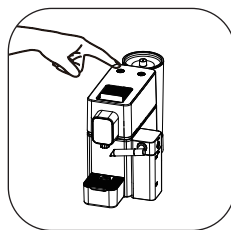

6. Press the milk or coffee button and the machine starts to warm up.

2. The making of milk coffee

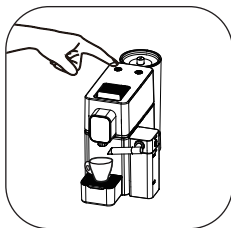

1. Warm the cup: Put the cup, press the coffee button, and pour water once.

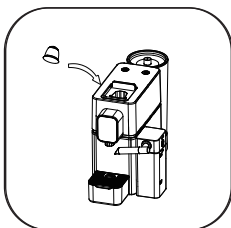

2. Open the slide and place the capsule.

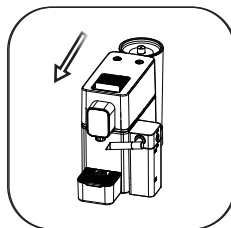

3. When the capsule is in, close the slide.

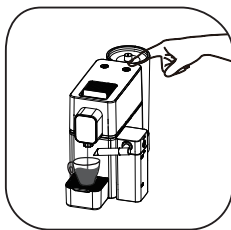

4. Press the milk coffee button, the milk coffee button indicator light continues to blink, the coffee button indicator light goes off, the default is to make about 90mL milk foam, extract about 50mL coffee, press any key to stop working during the process.

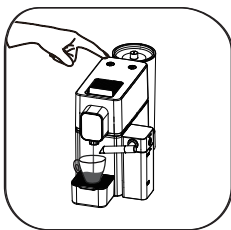

5. Press the coffee button, the coffee button indicator light continues to blink, the milk coffee button indicator light goes off, the default extraction is about 50mL coffee, press any key to stop extraction during the process.

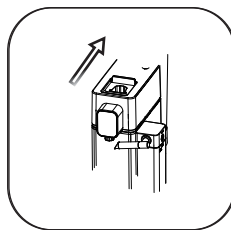

6. After extraction is complete, open the slide back and the capsule will automatically drop into the waste capsule box after use.

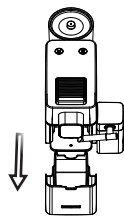

Waste capsule box cleaning tips

Hold the waste capsule box, gently pull out, you can pull out the waste capsule box, clean out the waste capsule inside, and then install it to complete the cleaning. The waste capsule basket can hold about 16 capsules.

3. Operation Prompt

1. During the preheating process, the key indicator of milk coffee and coffee will blink continuously at the same time, after about 30 seconds of preheating (due to the influence of external temperature, the time will have a certain error), at this time, the key indicator of milk coffee and coffee will stop blinking, the indicator will turn to steady on, and the water can be produced by pressing the key again.
2. When making the milk coffee, the machine will heat it again, and after heating for about 30 seconds, the milk foam will be made, and the milk foam amount is about 90mL; After making the milk foam, begin to extract the coffee, the amount of coffee is about 50mL; If the milk can is pulled out during the production of the milk coffee, the machine will stop working immediately.
3. If the machine is not equipped with milk can, after the preheating is completed, the milk coffee key indicator will be turned off. At this time, the milk coffee key is in the invalid state, and there is no reaction when pressed, only the coffee button can be operated.
4. The milk in the milk can, do not lower than the minimum scale line MIN, so as not to affect the effect of milk coffee.
5. For the first time use, or for a long time do not use, please do not place the capsule before use, and make a cup of water to clean the machine and make the coffee better.

EN



Do not inject hot water into the water tank, otherwise it will cause the water tank to break, and serious will lead to electric shock and other dangers.



Please note the highest water level indicating position (Max)!



This machine is only used with the specified capsule, please check with the distributor before use

Chapter IV: Function Introduction

1. Standby Function

1. In order to protect the machine and save energy, the machine will automatically enter the standby state after 25 minutes without operation.
2. Press the large cup button and the small cup button at the same time for 3 seconds to enter the standby state.
3. In standby state, both indicators are off. If you need to wake up, press any key.

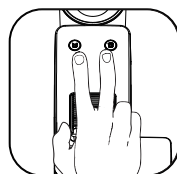

2. Restore Factory Default Settings

In the standby state, press the milk coffee button and the coffee button at the same time until the milk coffee button and the coffee button indicator blink for three times, and the system automatically restores the default temperature and flow gear.

3. Set the Coffee and Milk Flow

According to the user's habit, adjust the amount of coffee and milk foam when extracting coffee. The coffee machine can set the amount of coffee and milk foam respectively. After the machine is powered on and preheated, the coffee and milk coffee key indicator light is long and blue before the following operations can be carried out.

1. Coffee flow setting: Long press the coffee button for 5 seconds, release it, and the indicator flashes rapidly. When the coffee reaches the expected amount, press the coffee button to stop the machine from working, and the machine can remember the current amount of coffee. (PS: Coffee default flow: 50mL).
2. Milk foam setting: Long press the milk coffee button for 5 seconds, then release it, and the light flashes rapidly. When the milk output reaches the expected amount, press the milk coffee button to stop the machine, and the machine can remember the current milk foam amount. (PS: Milk foam default flow: 90mL)

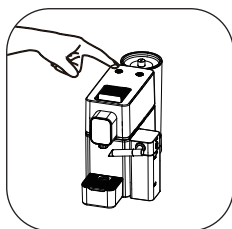

1. Coffee flow
Settings

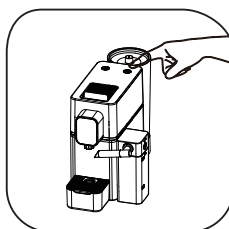

2. Milk foam
setting

4. Set Coffee Temperature

According to the user's habit, adjust the coffee temperature, the temperature setting has 7 gears, respectively: the system default gear, up 4 gears, down 2 gears, the machine can operate the following functions in the standby state.

1. Long press the coffee button for the first time, the red indicator flashes twice, and the temperature drops by one gear; Long press the small cup button for the second time, the red indicator flashes once, and the temperature drops by two gears.
2. Long press the milk coffee button indicator light blinking red: blink once, the temperature rises one gear; Long press the milk coffee button for the second time: blink twice, the temperature rises two gears; Long press the milk coffee button for the third time: blink 3 times, and the temperature rises 3 gears; Long press the milk coffee button for the fourth time: blink 4 times, and the temperature rises 4 gears.

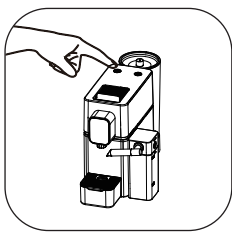

1. Press and hold the coffee button

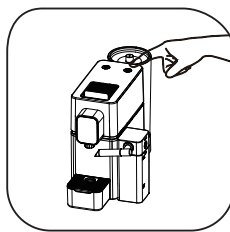

2. Press and hold the milk coffee button

5. Cleaning Function

1. Cleaning prompt: When the milk coffee is used for about 5 minutes, the machine will send a cleaning prompt, the milk coffee button light will flash red quickly, and emit 3 buzzes, 30 seconds later 3 rings, 10 seconds later the machine will return to standby state.
2. Remove the cleaning prompt: Pull out the milk jar and insert it in place. Remove the cleaning prompt and return to the ready state.
3. Manually enter the cleaning mode: When the working state is ready (the two indicators are blue), open the sliding cover, hold down the coffee and milk coffee buttons at the same time, close the sliding cover within 3 seconds, the milk coffee key indicator blinks blue, then the machine enters the cleaning mode, starts cleaning, lasts for about 50 seconds, and returns to the waiting state after cleaning.



Tips: For good use experience, please clean regularly, remove the milk can with clean water.

EN

6. Presoak Function

The default setting of the machine is that there is no soaking function when brewing coffee. If you need to use the soaking function, please set it as follows.

1. In the standby state (the machine is powered on, both indicators are off), open the sliding cover, hold down the coffee key and milk coffee key for about 3 seconds, and enter the program of setting the soak function.
2. If the coffee indicator is red and the milk coffee indicator is off, it means that the current soaking function is off. If the milk coffee indicator is red and the coffee indicator is off, it means that the current soaking function is on.
3. Press the coffee button. After the blue light of the coffee indicator flashes for three times, it turns to a red light for a long time, indicating that no soaking function is selected.
4. Press the milk coffee button. The blue light of the milk coffee indicator flashes three times and turns red for a long time, indicating that the immersion function is selected.
5. Hold down the coffee button and the coffee button for 3 seconds at the same time to return to the standby state. The setting is complete.

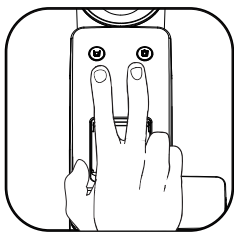

Open the slide and press both keys simultaneously.

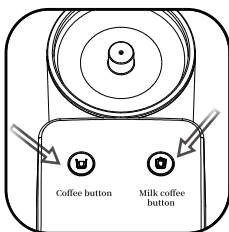

Select the corresponding key and press it.

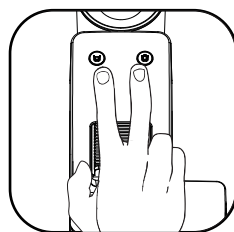

After pressing the indicator light and blinking, press the double key again to return to the standby state.



Please set whether to enable the soaking function according to the specific situation to achieve a better coffee effect.

Chapter V: Cleaning and Maintenance

Daily cleaning, cleaning and precautions.

1. Water tank cleaning: remove it and rinse it with clean water. If it is not clean, wipe it with a clean cotton cloth and then rinse it with water again.
2. Milk jar cleaning: After the milk jar is removed, the milk tube, milk jar, milk jar cover and other components can be separately cleaned in clean water.
3. Clean the waste water box: rinse it with clean water after removal. If it is not clean, wipe it with a clean cotton cloth and then rinse it with water again.
4. Appearance of the machine: Often wipe the appearance of the machine with a soft and slightly wet cotton cloth to keep the machine clean. When wiping, please turn off the power and unplug the machine to ensure safety.

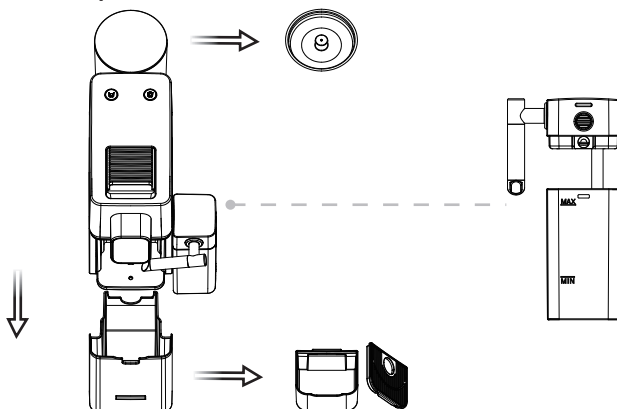

Note: Do not wash the machine or any part of the machine in the dishwasher.

Chapter VI: Technical Parameter _____

Model No.	H15
Power	1400W
Frequency	50-60Hz
Voltage	220V-230V
Weight	3.2KG
Milk Tank	0.3L
Water Tank	0.85L
Size	359*160*242mm

Chapter VII: Trouble Shooting _____

Problem	Solution
The light is not on.	Check whether the power cable is properly connected.
No Coffee.	1. Is there no water in the tank? Please fill with water and press the coffee button repeatedly to ensure the water supply is normal. 2. The used capsules are in the machine? Please change a new capsule.
The coffee is not warm enough.	1. Warm the cup with hot water. 2. Make sure the tank has water and is placed in place.
The slide cover does not open.	Turn off the machine or unplug the power, let the pressure of the coffee machine naturally release, and then open the slide cover.
The machine shuts down naturally.	In order to protect the machine and save energy, the machine wil automatically shut down after 25 minutes without operation.
All the lights are blinking.	Turn off the machine for 1 minute, and then turn on the machine.

EN

ENVIRONMENT FRIENDLY DISPOSAL

 	<p>You can help protect the environment!</p> <p>Please remember to respect the local regulations: hand in the non-working electrical equipments to an appropriate waste disposal center.</p>
--	--

Глава I: Меры предосторожности для безопасного использования

При использовании электроприборов необходимо соблюдать основные меры предосторожности, чтобы снизить риск возгорания, поражения электрическим током, травмирования людей и имущества. Перед использованием любого прибора прочтите все инструкции.

1. В случае чрезвычайной ситуации: Немедленно выньте вилку из электрической розетки.
2. Этот продукт используется только дома или в гостиничном номере, любое коммерческое или неправильное использование машины не в соответствии с инструкциями, производитель не несет никакой ответственности, если не используется в течение длительного времени, пожалуйста, отключите вилку.
3. Напряжение питания должно соответствовать данным, указанным на этикетке. Пожалуйста, используйте розетку с проводом заземления.
4. Во избежание возгорания ставьте кофеварку на ровную жаропрочную поверхность и не используйте ее вблизи открытого огня.
5. Если кофемашина повреждена, не используйте ее! При появлении ненормального шума или запаха выключите кофемашину и отсоедините источник питания. В этом случае обратитесь в авторизованный сервисный центр или к дистрибьютору!
6. Передвигайте слайд в обычных условиях. Не кладите руку на горлышко капсулы.
7. Во избежание опасности не открывайте крышку заслонки во время работы машины.
8. Не используйте машину без контейнера для капсул с отходами и бака.
9. Храните аппарат и провода в недоступном для детей месте.
10. Не наливайте горячую воду в резервуар для воды и не погружайте прибор в воду.
11. Не разбирайте машину и не помещайте в горлышко капсулы ничего, кроме указанной капсулы.
12. За исключением обычного использования, чистки и технического обслуживания, любые операции, не входящие в рамки данного руководства, могут выполняться только в авторизованном сервисном центре.
13. Используйте, если шнур питания не поврежден (если шнур питания поврежден, он должен быть заменен производителем, его отделом технического обслуживания или аналогичными специалистами во избежание опасности)
14. Не кладите шнур питания на горячие поверхности, острые края или другие острые предметы.
15. Не подвешивайте шнур питания (опасность спотыкания)
16. Никогда не прикасайтесь к проводу мокрыми руками.
17. Не вытаскивайте штекер, потянув за провод.
18. Дети старше 8 лет могут пользоваться этой кофеваркой под присмотром и должны быть осведомлены о связанных с ней опасностях.
19. Детям до 8 лет строго запрещено чистить и обслуживать кофемашину.
20. Держите кофеварки и шнуры питания подальше от детей младше 8 лет.
21. Данная кофемашина не предназначена для использования детьми или лицами с ограниченными умственными или физическими возможностями (если только такие лица не полностью усвоили правила эксплуатации и использования данной кофемашины). Лицам, не полностью освоившим управление и использование данной кофеварки, следует внимательно ознакомиться с данным руководством и полностью понять его содержание. При необходимости помогите понять, как ее использовать.
22. Регулярно и тщательно очищайте кофеварку.
23. Если не очищать кофемашину, длительное образование налета может нанести вред вашему здоровью. 3. Перед чисткой отключите кофеварку от сети и дайте ей остыть естественным образом.
24. Упаковочный материал подлежит вторичной переработке.
25. В целях защиты окружающей среды машина содержит материалы, которые могут быть переработаны или использованы повторно, пожалуйста, соберите их самостоятельно.